



**FLEXIBLE SECURITY
ENCLOSURE
CONSTRUCTION**



MODULEGUARD

BURGLARY-RESISTANT STRONG ROOMS AND VAULT DOORS



KEY FEATURES

- ModuleGuard security enclosures are certified Grade II-IV by ECB+S in accordance with the EN 1143-1 certification for burglary resistance.
- The rooms also offer approved protection against certain firearms.
- The security enclosures are constructed using modular, lightweight panels.
- The light weight reduces transportation costs, eases installation and allows for placement higher up in buildings where floor loads are limited.
- The modular construction means assembly, disassembly and expansion of a room are both quick and easy.
- The security enclosures can be built into the existing structure of a building and customised to meet the required dimensions.
- Possible applications are: reinforced protection for cash-counting rooms, archives, storerooms (for weapons, pharmaceuticals), ATMs, etc.
- A series of high-security locking options is available.
- The exterior of the enclosure is primed in RAL 7032 and can be finished with decorative panels.

MODULEGUARD

PRODUCT SPECIFICATIONS

Doors (mm, kg)

	2055	2055	2055	2055	2055	2055
Height (clear opening)	2055	2055	2055	2055	2055	2055
Width (clear opening)	750	900	1050	1200	1350	1500
Thickness	185	185	185	185	185	185
Weight: Gr II & III	690	830	970	1110	1250	1380
Weight: Gr IV	780	930	1090	1240	1400	1550

Panels (mm, kg)

Grade	II	III	IV
Thickness	75	75	75
Max Panel Length* (wall/roof)	3945	3945	2745/3945
Weight (kg/m ²)	104	108	200

* Without support structure - Floor load depends on the size of the enclosure.

MINIMUM ROOM MEASUREMENTS

To be certified, the room must be six-sided and meet the minimum dimension requirements below.

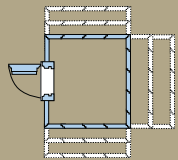

Height (External/Internal): 2290/2140mm
 Width (External/Internal): 2445/2295mm
 Depth (External/Internal): 1545/1395mm
 Weight: 3000kg

The specifications given are the minimum size for a certified ModuleGuard enclosure. They are based on a Grade III enclosure and a door with a clear opening width of 900mm. Larger sizes can be made to order. Please note, for extra large dimensions, an additional frame structure may be required for support.

BURGLARY TESTING

ModuleGuard has been approved by ECB•S in accordance with the European EN 1143-1 standard for burglary protection in Grades II, III and IV.

A range of attack tools were used to test ModuleGuard's level of resistance, from basic tools, such as drills and sledgehammers, to more sophisticated thermal and electrical equipment, such as an oxyacetylene torch.

LOCKS

SafeLock series, GSL 1000, LG 1947, S&G 6731, Kaba Mauer 70079.

Authorised dealer

www.chubbsafes.com